

REV. 1-19-92: GENERAL REVISION.

REV. 6-13-95: ADDED W20-1 AND SPECIAL SIGN FOR INTERSECTION RAMP AND STREETS.

REV. 5-27-98: CHANGED DRAWING NO. FROM T-CP-1A TO T-WZ-33. MODIFIED GENERAL NOTE D.

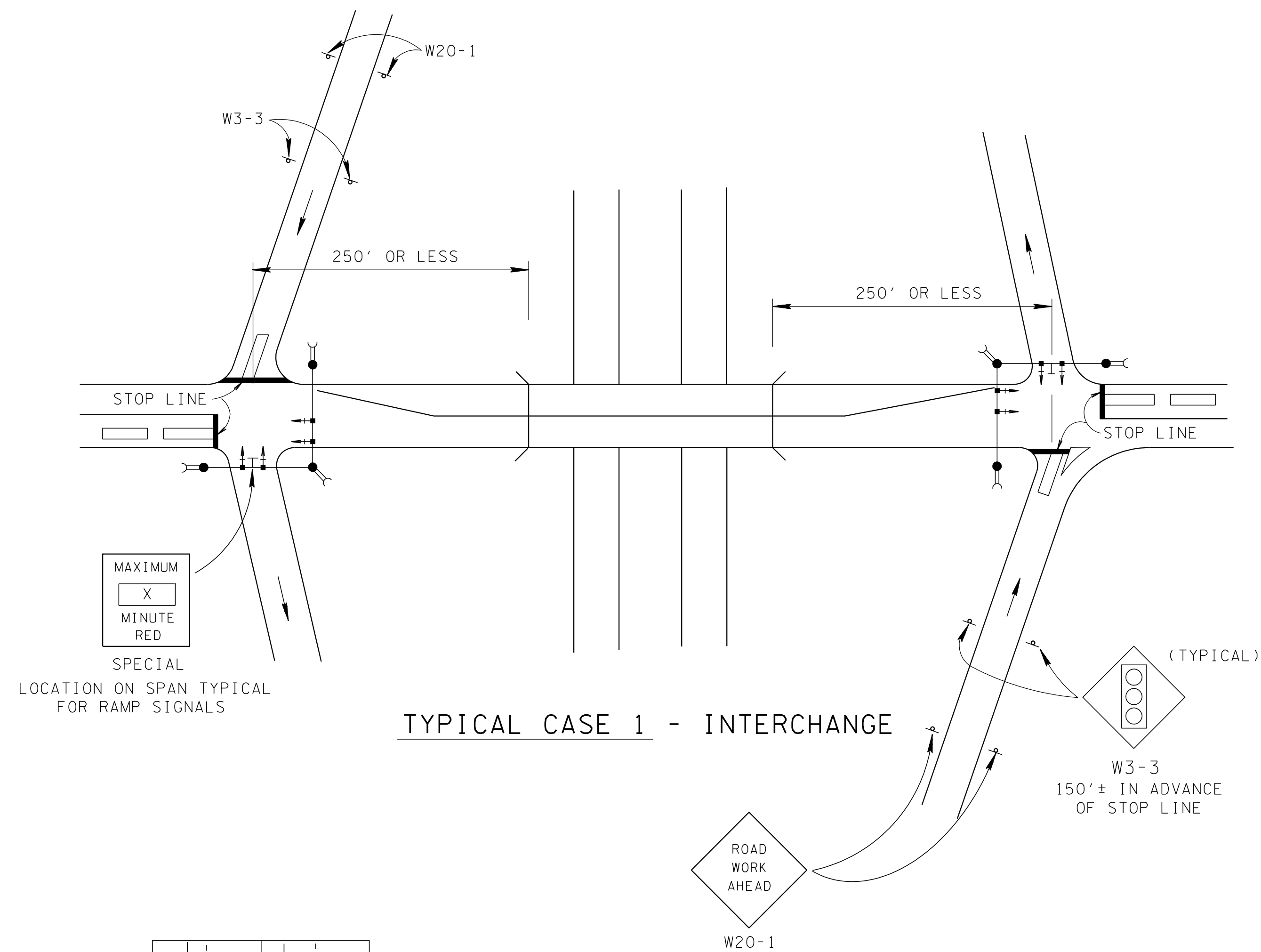

TYPICAL CASE 1 - INTERCHANGE

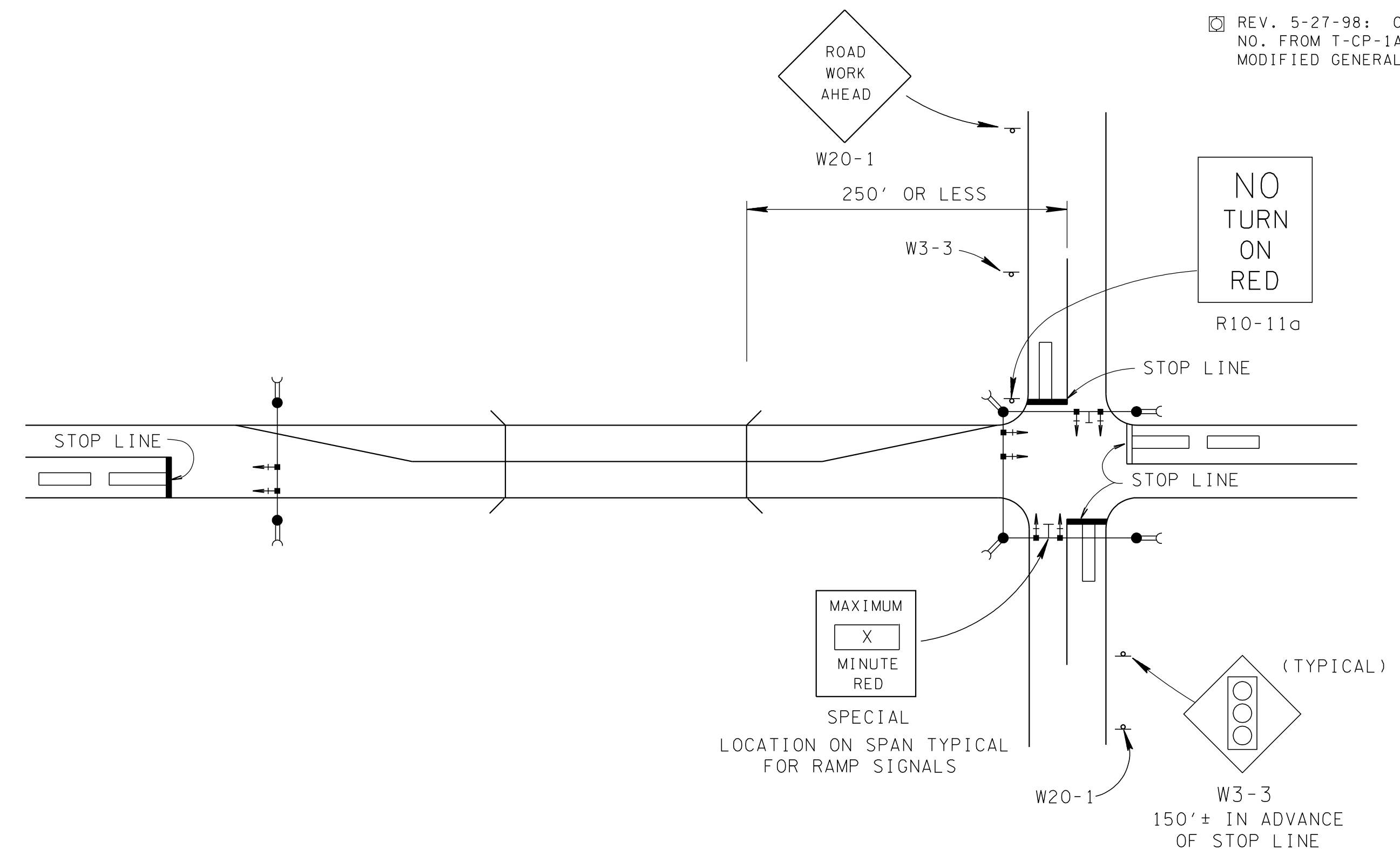

TYPICAL CASE 2 - CROSSING ROAD

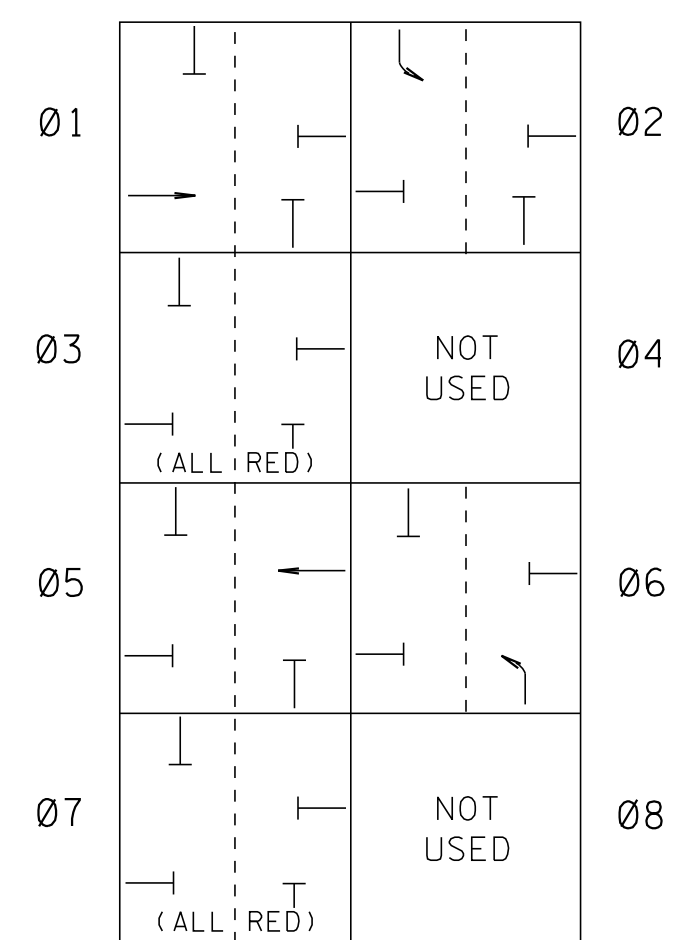

PHASING DIAGRAM

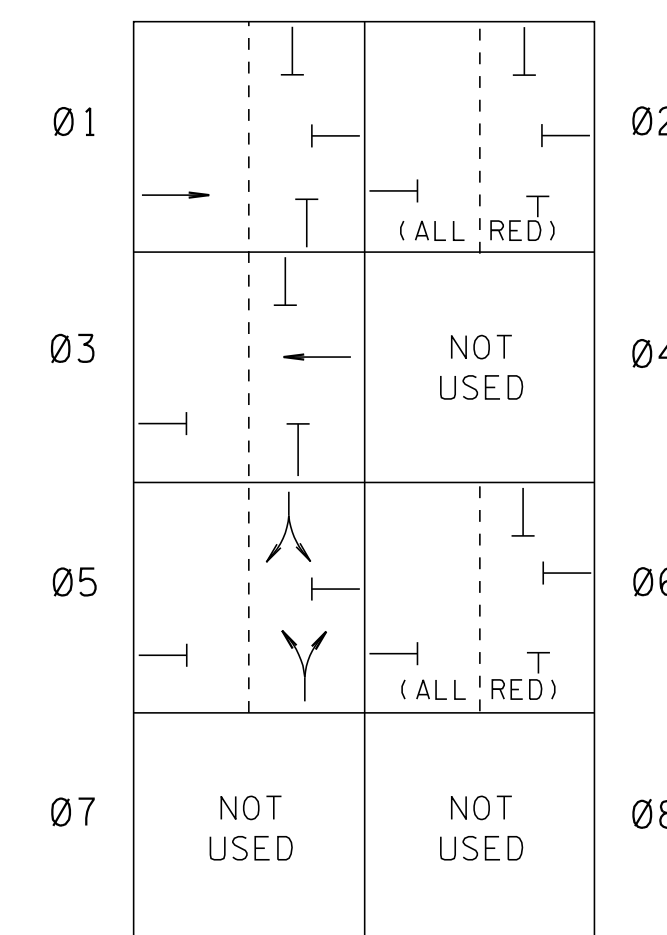
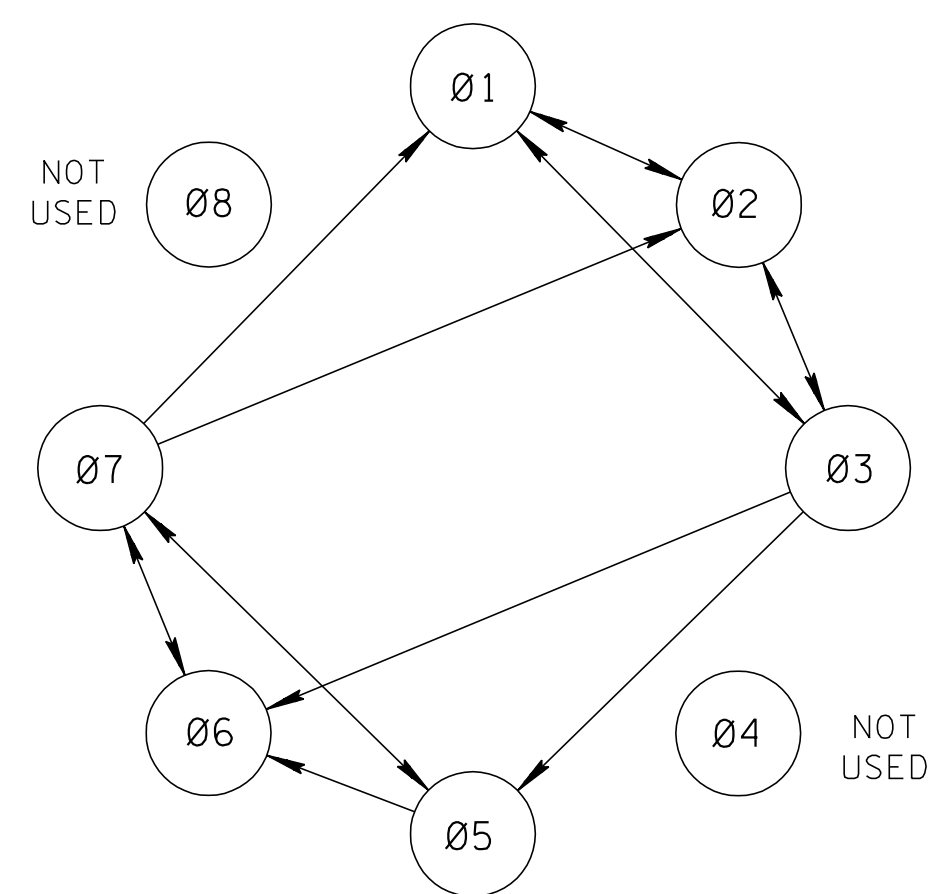

PHASING DIAGRAM

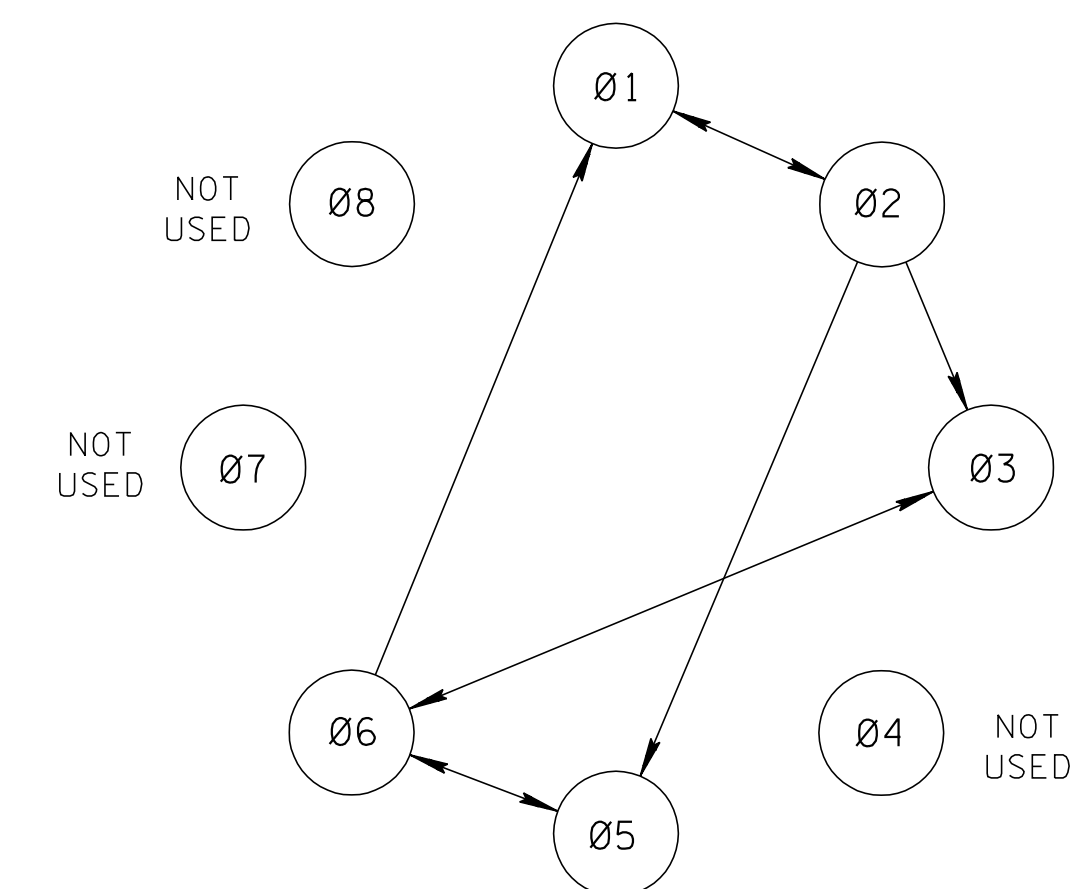

GENERAL NOTES

- (A) EXISTING STOP SIGNS ON RAMPS OR SIDE ROADS ARE TO BE REMOVED AND STORED. CONTRACTOR SHALL REINSTALL THEM IMMEDIATELY WHEN SIGNAL EQUIPMENT IS TURNED OFF FOR REMOVAL. COST TO BE INCLUDED IN THE PRICE BID FOR ITEM NO. 712-01, TRAFFIC CONTROL PER LUMP SUM.
- (B) DETECTION LOOPS ON RAMPS OR SIDE ROADS SHALL BE 1 AT 6'X45'. ALL LOOPS ARE CONNECTED TO DELAY DETECTORS.
- (C) INSTALL SIGNAL AHEAD SIGNS AND STOP LINES AS SHOWN. INSTALL "NO TURN ON RED" SIGN AS SHOWN.
- (D) SEE STANDARD DRAWING NOS. T-WZ-32, T-WZ-34 AND T-WZ-35 FOR OTHER NOTES AND DETAILS WHERE APPLICABLE.

MINOR REVISION -- FHWA APPROVAL NOT REQUIRED.

CROSS REFERENCE DRAWINGS FOR THIS SHEET: T-WZ-32, T-WZ-34 AND T-WZ-35.

SHEET NOT TO SCALE

STATE OF TENNESSEE
DEPARTMENT OF TRANSPORTATION

TRAFFIC CONTROL PLAN FOR CLOSE INTERSECTION CONDITIONS USING TRAFFIC SIGNAL AT TWO LANE BRIDGE RECONSTRUCTION SITE

5-27-98 T-WZ-33